

# *The Heart of Atherton*

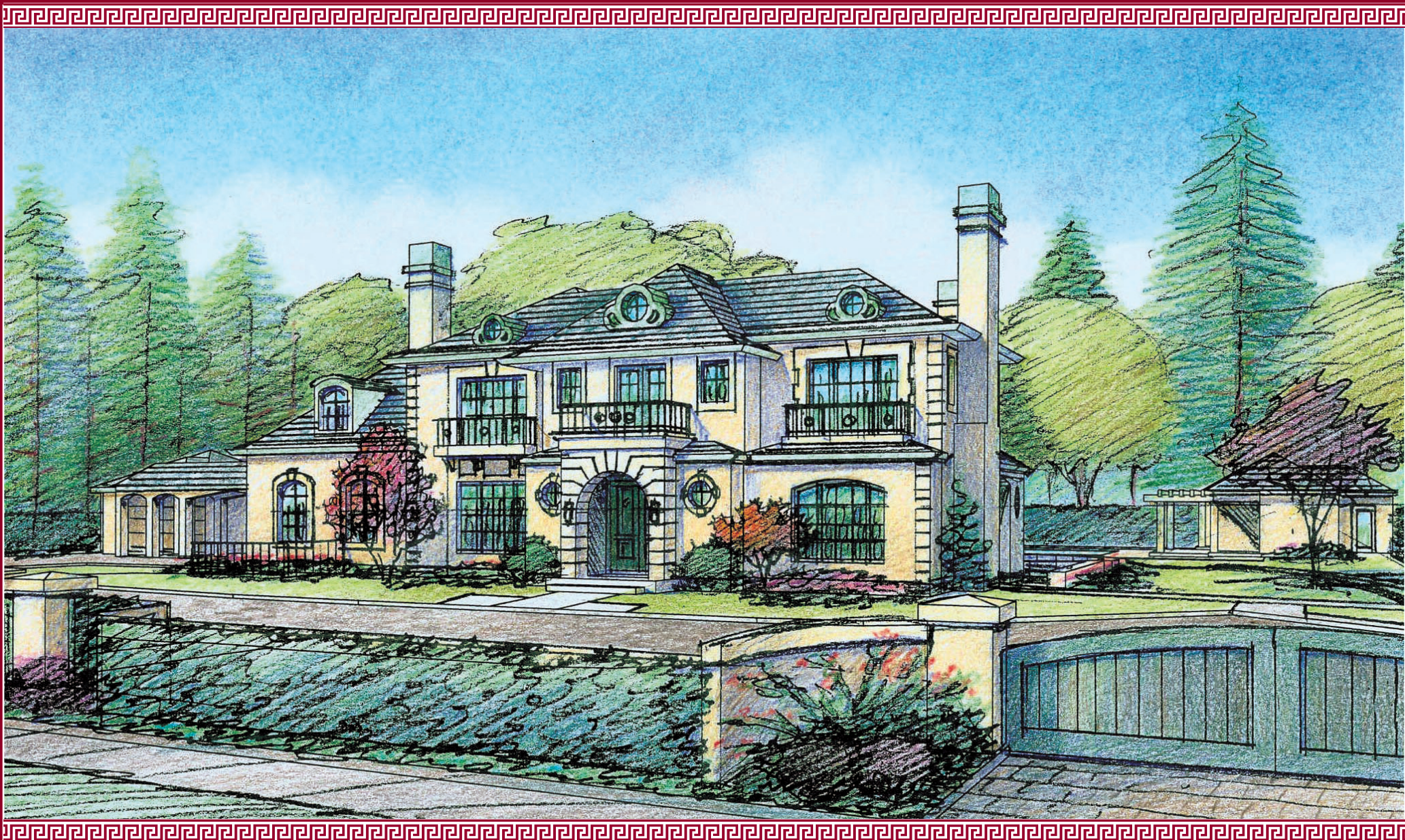

HUGH CORNISH *presents* 58 LINDA VISTA AVENUE ■ ATHERTON



Located on one of the most desirable streets in West Atherton, the beauty of this flat, rectangular parcel of approximately one acre is enhanced by mature perimeter trees. Plans for a magnificent, two-story, approximately 9,500-square foot residence, custom-designed by Pacific Peninsula Architecture, are included in the purchase price. Top-rated Menlo Park schools.

Offered at \$3,995,000

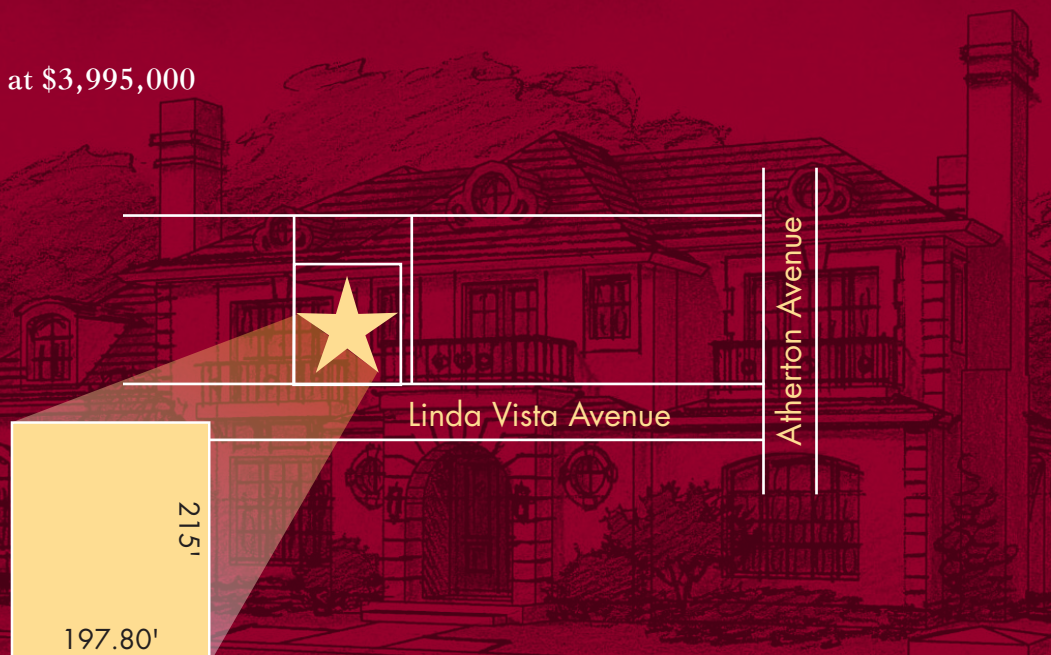

This information was supplied by Seller and/or other sources. Broker believes this information to be correct but has not verified this information and assumes no legal responsibility for its accuracy. Buyers should investigate these issues to their own satisfaction. Information deemed reliable, but not guaranteed.  
© Marketing Designs, Inc. 650.802.0888 • marketingdesigns.net

For more information on this property and others,  
please visit my Web site at:

**www.HUGHcornish.com**



# HUGH CORNISH

*#1 Individual Agent,  
2008 SF-Peninsula*

*#8 Individual Agent, 2008 Nationally*

**650-566-5353**

**hcornish@cbnorcal.com**

